

12.0 cu. ft. Bottom Freezer Refrigerator

- 12 cu. ft. Capacity
- Sleek Pocket Handle Design
- Door Cooling+
- Factory Installed Ice Maker
- Fingerprint Resistant Finish
- Reversible Door
- SmartDiagnosis™



COLOR AVAILABILITY

- LRBCC1204S – PrintProof™ Stainless Steel

CAPACITY

| | |
|--------------------------|-----|
| Refrigerator (cu. ft.) | 8.2 |
| Freezer (cu. ft.) | 3.8 |
| Total Capacity (cu. ft.) | 12 |

ENERGY

| | |
|---------------------------------|-----|
| Energy Consumption (kWh / Year) | 486 |
| ENERGY STAR® Qualified | Yes |

WATER & ICE SYSTEM

| | |
|-----------------------------|-----------------------------|
| Ice & Water Dispenser | No |
| Ice System | Factory Installed Ice Maker |
| Daily Ice Production (lbs.) | 3.0 lbs. |
| IcePlus™ Production (lbs.) | 3.2 lbs. |
| Ice Storage Capacity (lbs.) | 4.5 lbs. |
| Water Filter | No |

COOLING

| | |
|------------------------|----------------|
| Compressor Type | Smart Inverter |
| Dual Evaporators | No |
| Cooling System | Standard |
| Multi-Air Flow™ System | Yes |
| Door Cooling+ | Yes |
| Temperature Sensors | 4 |
| Fresh Air Filter | No |

CONVENIENCE

| | |
|----------------------------|------------------------|
| Display Type | Membrane (White LED) |
| Temperature Controls | Electronic / Digital |
| Door Alarm | Yes |
| Child Lock | No |
| Auto Closing Door Hinge | Yes |
| ADA Compliant | No |
| Sabbath Mode | Yes (Star-K Certified) |
| LoDecibel™ Quiet Operation | Yes |

REFRIGERATOR

| | |
|-------------------------------|---|
| No. of Shelves | 3 Full Width (2 Adjustable) |
| Shelf Construction | Tempered Glass |
| Crisper Bins | 1 Fresh Vegetable Drawer & 1 Fresh Converter Drawer |
| Glide N' Serve™ Pantry Drawer | No |
| Cool Guard | No |
| Refrigerator Light | Ceiling LED |

REFRIGERATOR DOOR

| | |
|-----------------------|-----------------|
| No. of Door Bins | 3 Full Width |
| Door Bin Construction | 1 Piece (Clear) |

FREEZER

| | |
|-----------------|-------------------------------|
| Freezer Type | Swing Door |
| Freezer Drawers | 2 |
| No. of Shelves | 1 |
| Ice Storage | Icemaker & Ice Bin in Freezer |
| Freezer Light | No |
| Freezer Handle | Pocket Handle |

SMART FEATURES

| | |
|-----------------|-----|
| Wi-Fi Enabled | No |
| ThinQ® | No |
| SmartDiagnosis™ | Yes |

MATERIALS AND FINISHES

| | |
|---|----------------|
| Hidden Hinges | Yes |
| Surface | Smooth |
| Fingerprint & Smudge Resistant Exterior | Yes |
| Handles | Pocket Handles |

TECHNICAL SPECS

| | |
|----------------------------|----------------------|
| Required Power Supply | 115 V, 60 Hz, 15 Amp |
| Plug Type | 3-Prong |
| Power Cord Location | Back |
| Min. / Max. Water Pressure | 20–120 psi |

DIMENSIONS / CLEARANCES / WEIGHTS

| | |
|--------------------------------------|-------------------------------|
| Depth with Handles | 26 5/8" |
| Depth without Handles | 26 5/8" |
| Depth without Door | 24" |
| Depth (Total with Door Open) | 48 3/16" |
| Height to Top of Case | 73 1/4" |
| Height to Top of Door Hinge | 73 1/4" |
| Width | 23 1/2" |
| Width (Door Open 90° with Handle) | 23 13/16" |
| Width (Door Open 90° without Handle) | 23 13/16" |
| Door Edge Clearance with Handle | 2" |
| Door Edge Clearance without Handle | 2" |
| Installation Clearance | Sides 2", Top 2", Back 2" |
| Approx. Weight (Product / Carton) | 154 lbs. / 172 lbs. |
| Carton Dimensions (W x H x D) | 25 3/16" x 76 5/16" x 29 5/8" |

LIMITED WARRANTY

| | |
|---|----------|
| Parts & Labor | 1 Year |
| Sealed System (Parts & Labor) | 5 Years |
| Compressor (Parts & Labor) | 5 Years |
| Linear / Inverter Compressor (Parts Only) | 10 Years |

DIMENSIONS / CLEARANCES

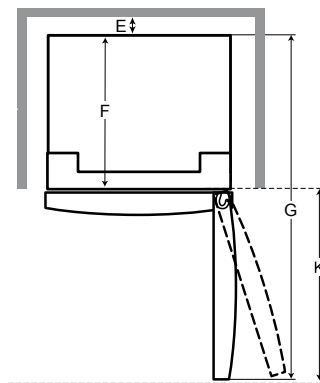
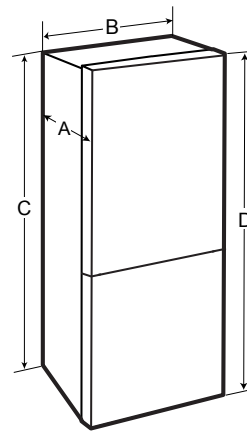

DIMENSIONS / CLEARANCES

| | | |
|---|----------------------------------|--------------------|
| A | Depth without Handles | 26 5/8" (677 mm) |
| B | Width | 23 1/2" (595 mm) |
| C | Height to Top of Case | 73 1/4" (1860 mm) |
| D | Height to Top of Hinge | 73 1/4" (1862 mm) |
| E | Back Clearance | 2" (50 mm) |
| F | Depth without Door | 24" (610 mm) |
| G | Depth (Total with Door Open 90°) | 48 3/16" (1225 mm) |
| K | Front Clearance | 29 1/8" (740 mm) |

INSTALLATION NOTES

- The installation location chosen for the refrigerator should allow space behind the unit for connections and airflow and space in front to open the doors and drawers.
- Too small of a distance from adjacent items may result in lowered freezing capability and increased electricity consumption charges. Allow at least 29 1/8 inches (740 mm) in front of the refrigerator to open the doors, and at least 2 inches (50.8 mm) between the back of the refrigerator and the wall.